

Appearance



Description

BBO crystal has a broad transmission range from 210nm to 2000nm. Compared with DKDP and LiNbO₃ crystal, BBO crystal performs better in high power handling because of its good shutoff switching properties although it has a small electro-optic coefficient. It's ideal for application of high average power and high repetition rate Q-switching and regenerative amplifier system.

Features

- Range through UV to NIR (210nm-2000nm)
- Low absorption loss
- Small piezoelectric ringing effect
- Good temperature stability
- High extinction ratio
- Small capacitance value, fast switching speed
- High repetition rate, repetition rate up to 100KHz

Application

- High repetition rate DPSS Q-Switch
- High repetition rate
- Regenerative Amplifier control
- Cavity Dumping
- Beam Chopper

Standard Specifications

P/N	Clear aperture (mm)	Transmission typical(%)	Extinction ratio (voltage-free)	Λ/4-voltage	Capacity(PF)
BPC-3	2.6	98	>1000:1	3.5kV	≤3
BPC-4	3.6	98	>1000:1	4.9kV	≤3
BPC-5	4.6	98	>1000:1	5.9kV	≤3
BPC-6	5.6	98	>1000:1	7.3kV	≤3
BPC-3L	2.6	98	>1000:1	2.8kV	≤3
BPC-4L	3.6	98	>1000:1	3.9kV	≤3
BPC-5L	4.6	98	>1000:1	4.7kV	≤3
BPC-6L	5.6	98	>1000:1	5.8kV	≤3

Changchun New Industries Optoelectronics Tech. Co., Ltd

<http://www.cnioptics.com>

◆ CONTACT

No.888, Jinhua Road, High-tech zone, Changchun 130103, China

Email: sales@cnioptics.com

Phone: 0086-431-87034313

Fax: 0086-431-87033597

Mechanical Dimension

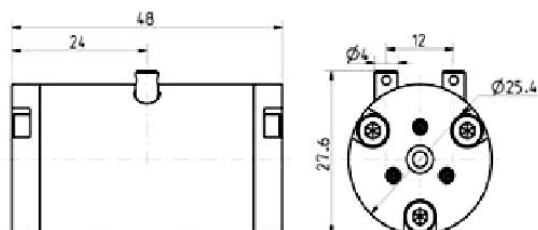

KDP Pockels Cells DPC series

Features

- Range through UV to NIR (210nm-2000nm)
- Low absorption loss
- Small piezoelectric ringing effect
- Good temperature stability
- High extinction ratio
- Small capacitance value, fast switching speed
- High repetition rate, repetition rate up to 100KHz
- Compact structure

Description

KD*P Q-Switch alters the polarization state of light passing through it when an applied voltage induces birefringence changes in an electro-optic crystal. When used in conjunction with polarizers, these cells can function as optical switches, or laser Q-switches

Application

- OEM laser systems
- Medical/cosmetic lasers
- Versatile R&D laser platforms
- Military & aerospace laser systems

Standard Products Specifications

P/N	Clear aperture (mm)	Transmission Typical (%)	Extinction ratio (voltage-free)	$\Lambda/4$ -voltage	Capacity(PF)
DPC-8	8	98	>1000:1	3.2kV at 1064nm, 20°C	≤ 6
DPC-10	10	98	>1000:1	3.2kV at 1064nm, 20°C	≤ 6