



Characteristics
Output Power 10W
Fiber Coupling 105μm
Fiber Core Dia. 0.22NA
Fiber laser feedback protection
Wavelength 915nm
Application
Fiber laser pumping, Medical use, Material processing

Parameter		Symbol	Typical	Unit
Optical	CW Out Power	$P_{op}$	10	W
	Center Wavelength	$\lambda$	915±10	nm
	Spectral Width (90% of Power)	$\Delta\lambda$	<6.0	nm
	Wavelength Shift width Temperature	$\Delta\lambda/\Delta T$	0.3	nm / °C
	Feedback protection (1030-1100nm)	FP	>40	dB
Electrical	Threshold Current	$I_{th}$	0.7	A
	Operating current	$I_{op}$	11.7	A
	Operating Voltage	$V_{op}$	1.7	V
	Slop Efficiency	$\eta_{es}$	0.9	W / A
	Power Conversion Efficiency	$\eta_{ep}$	49	%
Fiber	Fiber Core Diameter	$d_{core}$	105	μm
	Fiber Cladding Diameter	$d_{clad}$	125	μm
	Fiber Buffer Diameter	$d_{buffer}$	250	μm
	Numerical Aperture	NA	0.22	-
	Fiber Length	L	1.0	m

Changchun New Industries Optoelectronics Tech. Co., Ltd

<http://www.cnilaser.com>

◆ CONTACT

No.888, Jinhua Road, High-tech zone, Changchun 130103, China

Phone: 0086-431-87033597

Fax: 0086-431-87033597

## Other Parameters

Parameter	Operating Temperature/°C	Operating Relative Humidity/%	Storage Temperature/°C	Storage Relative Humidity/%	Lead Soldering Temperature, 10s max/°C
Min	10	-	-20	-	-
Max	40	75	80	90	250

## Package Dimensions (mm)

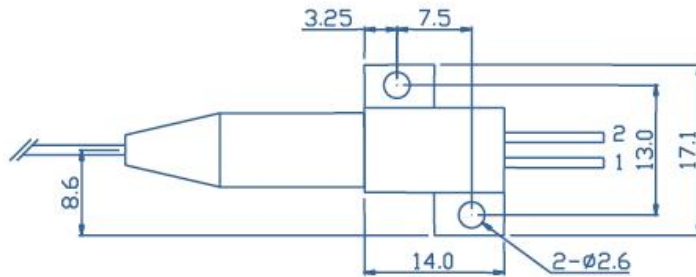
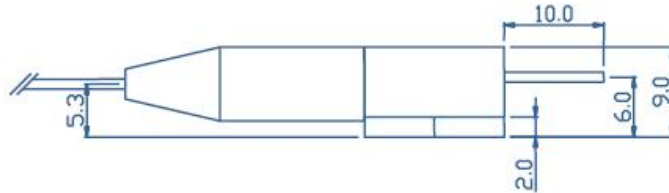
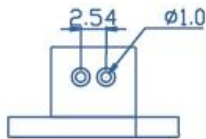

Pins and Functions	
Pin	Function
1	LD(+)
2	LD(-)



Changchun New Industries Optoelectronics Tech. Co., Ltd

<http://www.cnilaser.com>

### ◆ CONTACT

No.888, Jinhua Road, High-tech zone, Changchun 130103, China

Phone: 0086-431-87033597

Fax: 0086-431-87033597

## 915nm Diode Laser Characteristics (25°C)

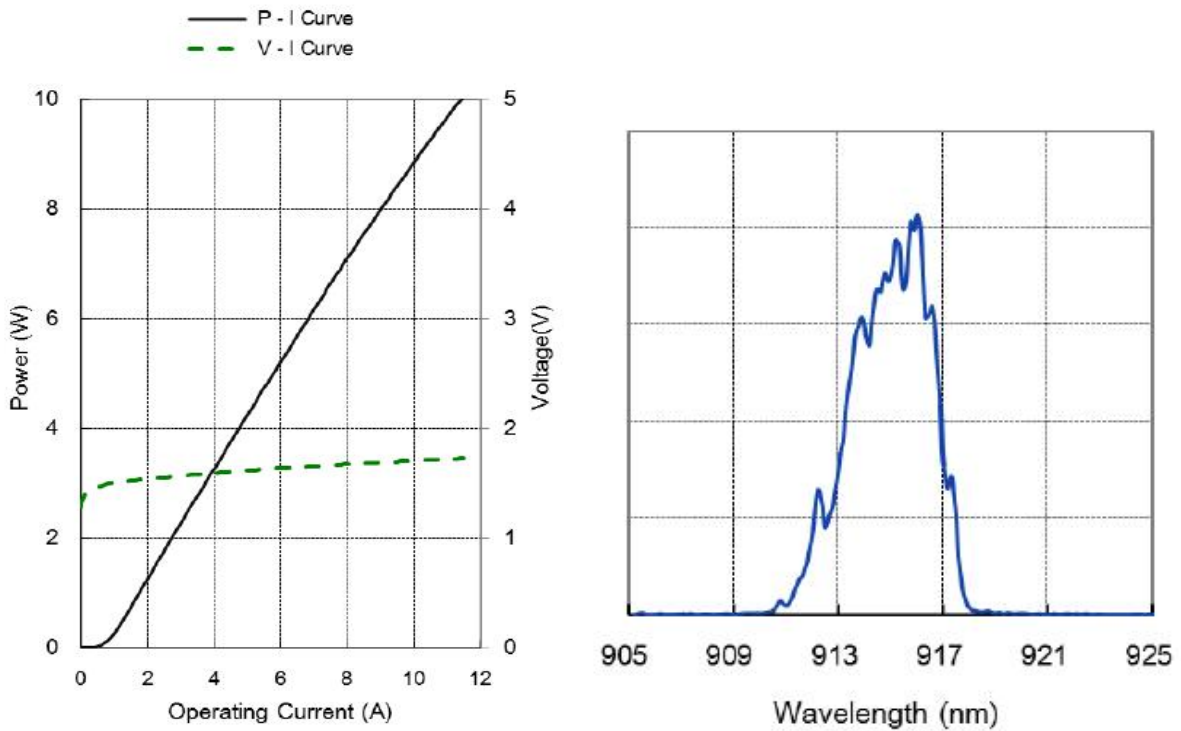

Changchun New Industries Optoelectronics Tech. Co., Ltd  
<http://www.cnilaser.com>

### ◆ CONTACT

No.888, Jinhu Road, High-tech zone, Changchun  
130103, China

Phone: 0086-431-87033597

Fax: 0086-431-87033597

